

REQUIRED TOOLS FOR INSTALLATION

OPEN ROLL, MODELS Z-125 | Z-150

Tape Measure

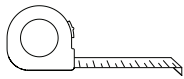

Level

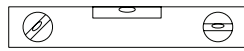

Power Drill / Screwdriver

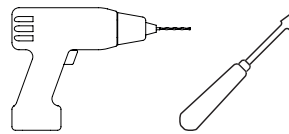

Pencil

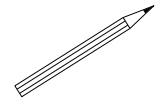

COMES WITH YOUR ORDER

Valance

If Ordered

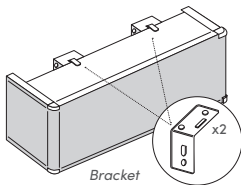

*Note: Valance Returns are optional

Shade Brackets

SpringDrive | WandControl | E-Touch

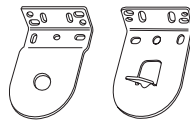

Idler-end Bracket
Control-end Bracket

Shade Brackets

ChainGuard

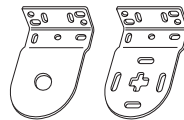

Idler-end Bracket
Clutch-end Bracket

Screws



Roller Shade

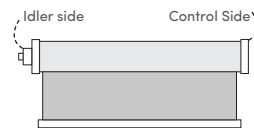

End Caps

If Ordered

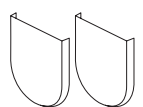

ROLLER SHADE INSTALLATION INSTRUCTIONS

STEP 1 - VALANCE INSTALLATION (If Ordered)

NOTES

- Valance must be installed as a first step before the Roller Shade. If you didn't order a Valance proceed to Step 2.

A - For INSIDE mount, divide valance width into thirds and mark 2 screw holes on the underside of the valance. Drill through cover to secure the valance in place.

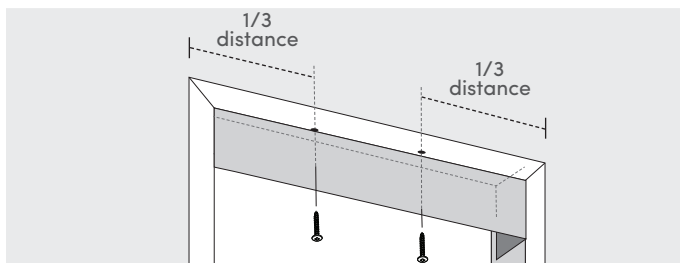

B - For OUTSIDE mount, mark the location of the shade mounting brackets with a pencil (see step 2), and measure 1/2" from the top of the bracket to note the location of the Valance bracket. Valance brackets should be installed 5"-8" from each end of the valance. Additional bracket(s) may be necessary and should be evenly spaced between the two ends brackets if required.

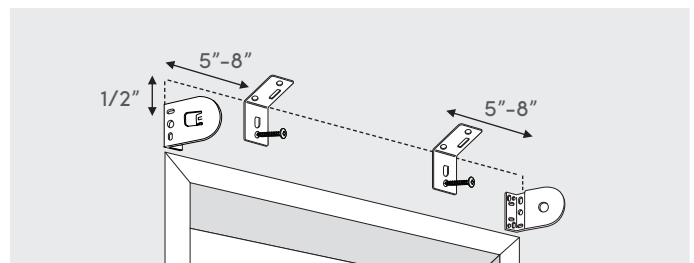

STEP 2 - BRACKET INSTALLATION

NOTES

- Before fully installing your brackets, note the difference between the control and idler brackets.
- In order to ensure the shade does not fall out of the brackets, it is critical that the idler pin is **securely compressed by at least 1/4"** upon installation. If pin is too loose, shade may fall out of brackets. If pin is compressed too tightly, shade may not operate properly. To prevent this, please ensure brackets are installed the exact width ordered.
- End caps are not required when installing a valance or for inside mount installation.

Idler pin must compress at least 1/4" to ensure shade is properly secured in the brackets.

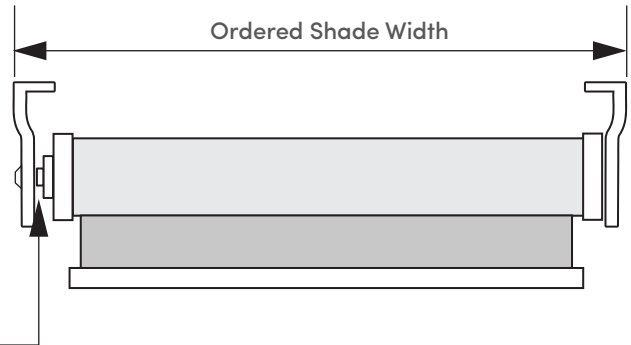

BRACKET INSTALLATION

Brackets can be positioned for inside mount or outside mount installations. Install the brackets according to L or R side controls.

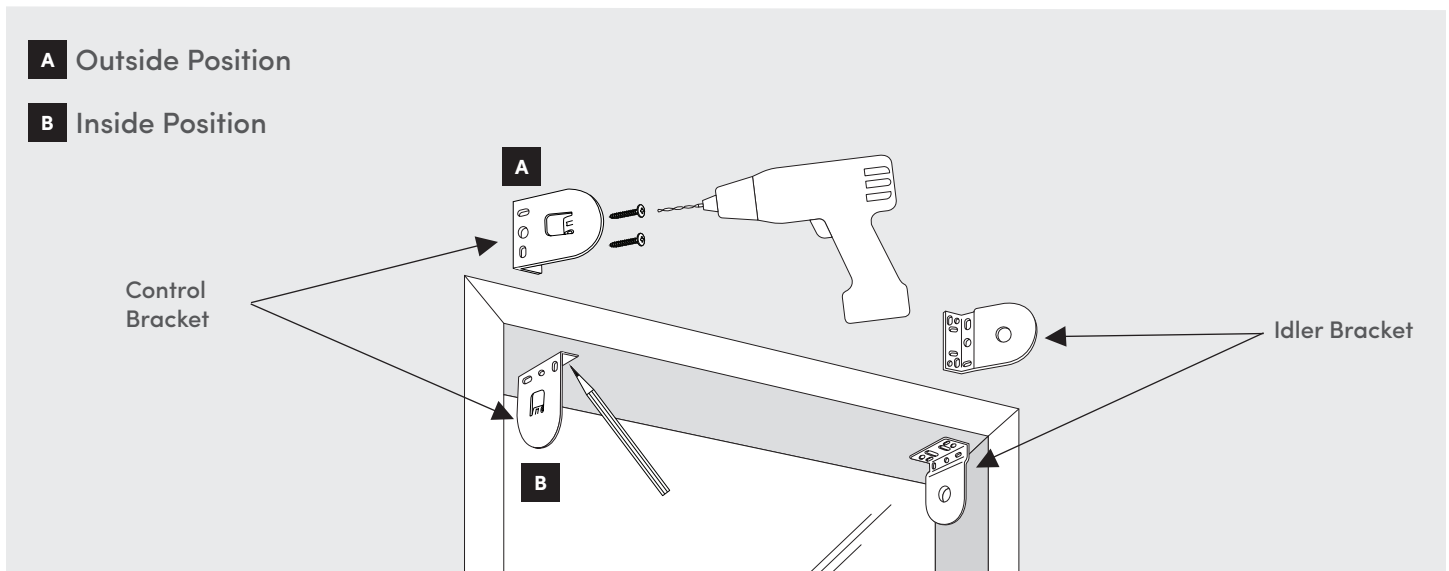

Inside / Outside Mount: Using a steel measuring tape, measure the distance from the **outside edge** of each bracket according to the ordered shade width. Mark the screw location on the mounting surface with a pencil ensuring these are leveled, snap end caps onto brackets (if ordered).

Fasten brackets according to Left or Right side controls in the marked locations using the screws provided (drywall plugs, if required, can be purchased from a local hardware store). Ensure brackets are secure, leveled, parallel and facing towards each other.

NOTES

- Ensure fabric rolls in the direction you specified (regular or reverse roll)
- Your control side depends on what you specified in your order

Regular Roll

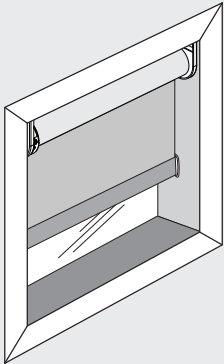

Fabric rolls off the back of the tube, closest to the window

Reverse Roll

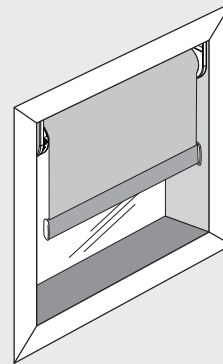

Fabric rolls off the front of the tube, into the room.

STEP 3 - SPRINGDRIVE | WANDCONTROL | E-TOUCH SHADE INSTALLATION

A - Insert the control-end bracket lip into the control side.

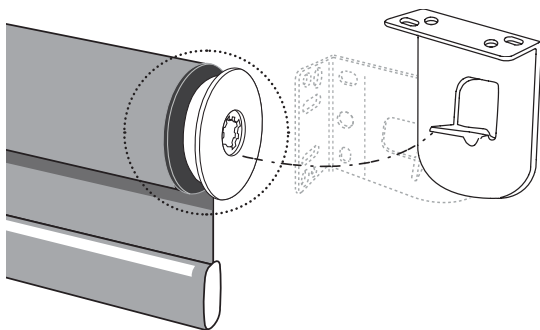

B - The idler end has a spring-loaded pin that allows it to compress in/out. Compress the pin and insert the idler-end into the idler-end bracket.

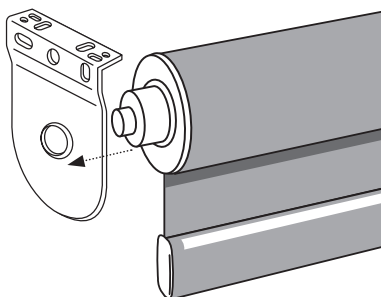

STEP 3 - CHAINGUARD SHADE INSTALLATION

A - The idler end has spring-loaded pin that allows it to compress in /out. Insert the idler-end into the idler-end bracket, compress and hook the clutch side into the "+" shape of the clutch bracket.

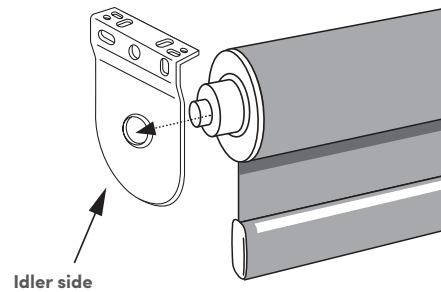

B - Ensure hook on the clutch side is pointing downward and securely fastens into the "+" shaped opening of the clutch bracket.

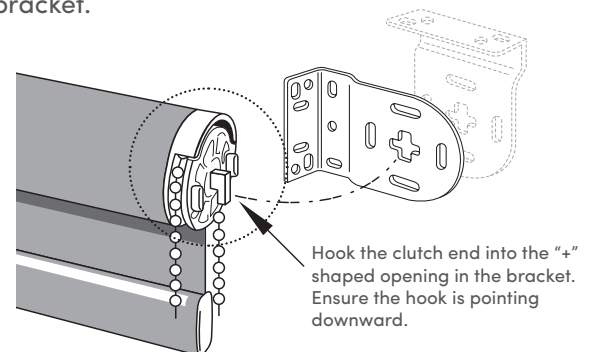

STEP 4 - APPLIES TO CHAIN OPERATION ONLY

CHILD/SAFETY CHAIN TENSIONER INSTALLATION

This device **MUST** be properly installed in accordance with Health Canada regulations on corded window covering products. Fasten P-Clip against the window frame or wall. Position the P-Clip so it does not interfere with the travel of the shade. Chain should be tight, but not under stress when adhered to the P-Clip. Fasten the P-Clip using screws provided. **Do not twist the chain. ChainGuard will rest on P-Clip.**

To operate the chain slide ChainGuard up, exposing the bottom of the chain. Use the exposed chain to raise or lower your shade accordingly. Release the ChainGuard to conceal the chain.

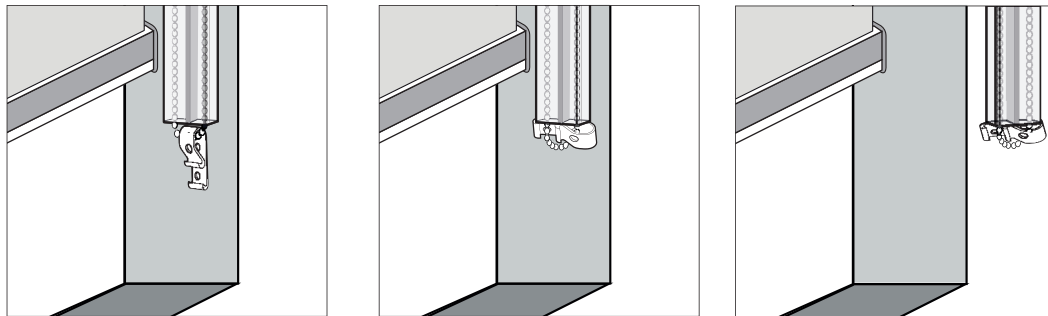

FABRIC ADJUSTMENT

If telescoping occurs, roll your shade down a few inches pass the window sill and place tape on the fabric as close to the top as possible on the side you want to bring down. Repeat this process as many times as necessary by layering the tape.

MAINTENANCE & CARE

Fabrics can be periodically dusted using a soft cloth, feather duster, or vacuum cleaner with brush attachment. If staining does occur, most fabrics can be cleaned using a soft cloth with water or a mild soap detergent. Any detergent or cleaning product should be tested on a small area prior to cleaning the fabric. Do NOT use abrasives or harsh cleansers as they can damage the fabric. Dab with a cloth or towel to prevent water spots and roll shade down to the window sill to allow the fabric to air-dry.

⚠ WARNING

STRANGULATION HAZARD: Young children can be strangled by cords. Immediately remove this product if a cord longer than 22cm or a loop exceeding 44cm around becomes accessible.



For french installation instructions, scan the QR code.

REQUIRED TOOLS FOR INSTALLATION

CASSETTE, MODELS S-300 | S-325 | V-80 | V-90

Tape Measure

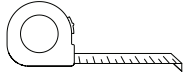

Level



Power Drill / Screwdriver

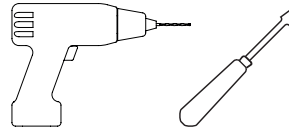

Pencil

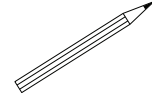

COMES WITH YOUR ORDER

S-300 Brackets

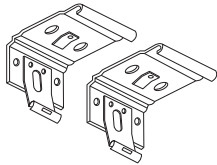

S-325 / V-80 / V-90 Brackets

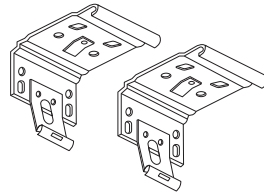

Screws



Applications



Roller Shades



High-Lite Shades



Sheer Horizontal

Shade Width (")	# of Brackets Supplied
0 - 60	2
60 - 84	3
84+	4

CASSETTE INSTRUCTIONS

STEP 1 - BRACKET INSTALLATION

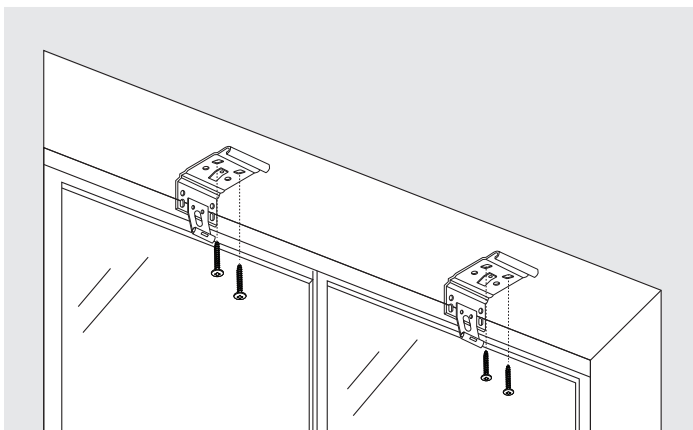

Inside Mount

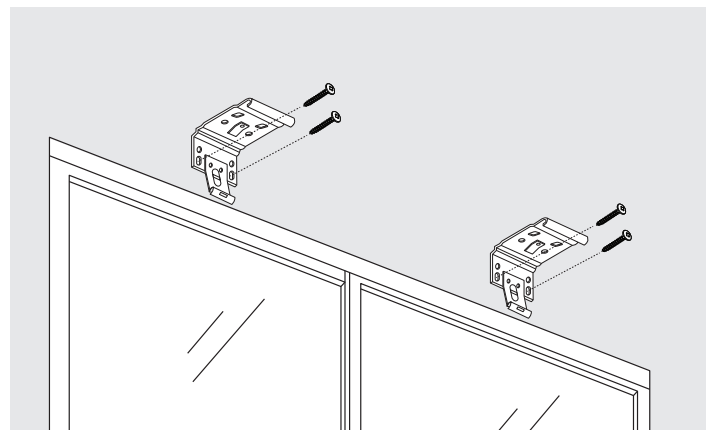

Outside/Wall Mount

Mark the cassette placement on the mounting surface. Install the brackets approximately 2" from either end of the cassette (drywall plugs, if required, can be purchased from a local hardware store). Ensure each bracket is level and in alignment with one another. Brackets should be securely placed allowing slight movement to adjust.

S-300 Cassette

2 7/8" H x 3 1/8" W

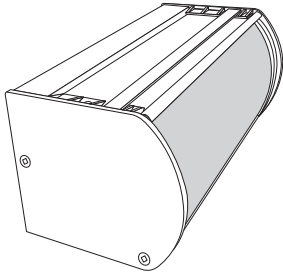

S-325 Cassette

3 1/8" H x 3 1/2" W

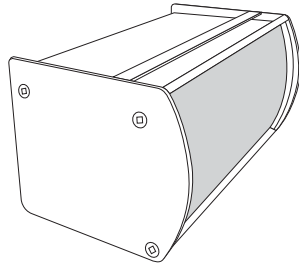

V-80 Cassette

3 3/8" H x 3 1/8" W

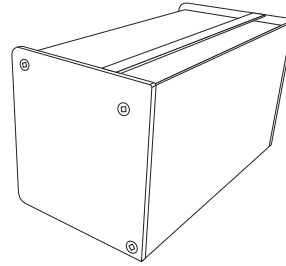

V-90 Cassette

5" H x 3 7/16" W

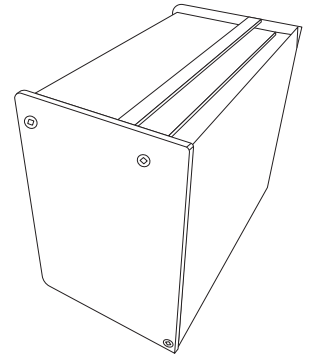

STEP 2 - MOUNTING THE SHADE (S-300 | S-325)

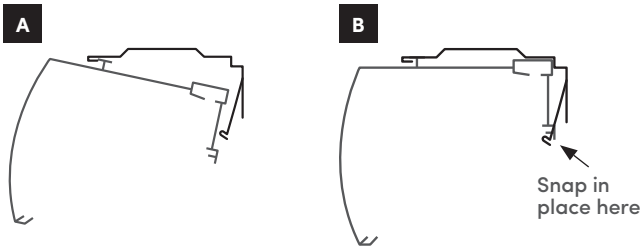

STEP 2 - MOUNTING THE SHADE (V-80 | V-90)

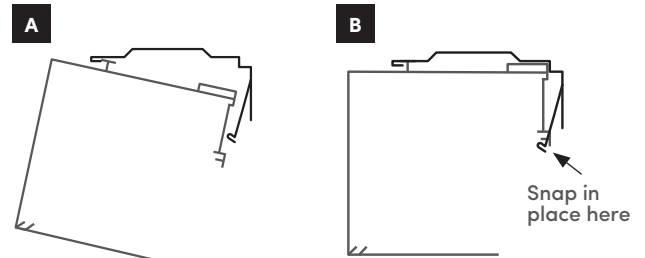

Hook the front of the cassette onto each bracket as shown in (fig.A). Pivot the cassette back and snap into place (fig.B) on each bracket ensuring a tight and secure fit.

NOTES

- DO NOT manipulate fabric roll when snapping cassette into place.

STEP 3 - REMOVING THE SHADE (IF NECESSARY)

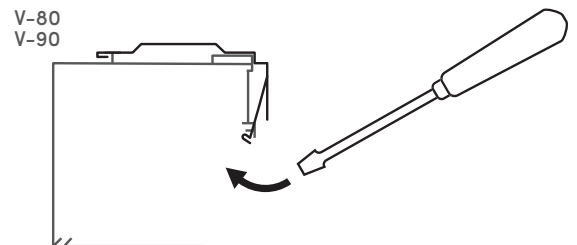
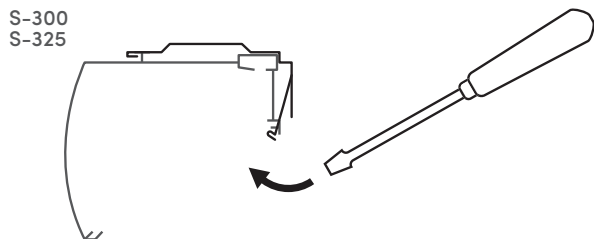

Insert a flat head screwdriver, between the bracket and cassette as shown. Gently pry the spring clip off the bracket of the cassette to unhook. The cassette should disengage from the bracket.

STEP 4 - APPLIES TO CHAINGUARD ONLY

CHILD/SAFETY CHAIN TENSIONER INSTALLATION

This device **MUST** be properly installed in accordance with Health Canada regulations on corded window covering products. Fasten P-Clip against the window frame or wall. Position the P-Clip so it does not interfere with the travel of the shade. Chain should be tight, but not under stress when adhered to the P-Clip. Fasten the P-Clip using screws provided. **Do not twist the chain.**

To operate the chain slide ChainGuard up, exposing the bottom of the chain. Use the exposed chain to raise or lower your shade accordingly. Release the ChainGuard to conceal the chain.

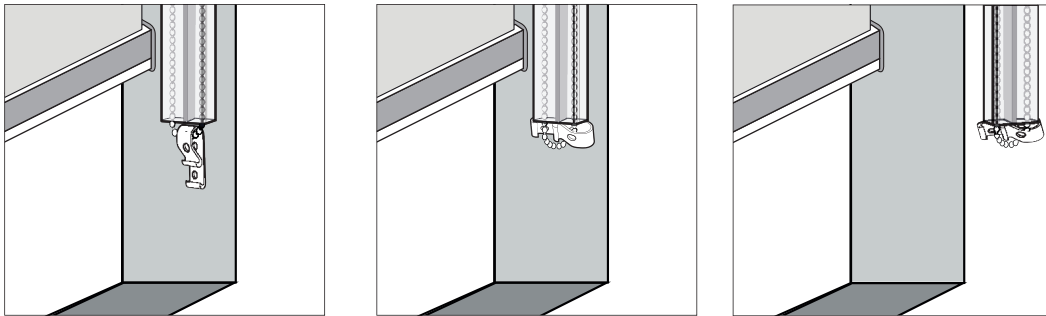

FABRIC ADJUSTMENT

ROLLER & HIGH-LITE SHADES: If telescoping occurs, roll your shade down a few inches past the window sill and place tape on the fabric as close to the top as possible on the side you want to bring down. Repeat this process as many times as necessary by layering the tape.

SHEER HORIZONTAL SHADES: Unlock the plastic clips under the bottom bar and operate the shade up/down until it rolls straight then lock the weight bar back into place.

MAINTENANCE & CARE

Fabrics can be periodically dusted using a soft cloth, can air duster, feather duster, or vacuum cleaner with brush attachment. If staining does occur, most fabrics can be cleaned using a soft cloth with water or a mild soap detergent. Any detergent or cleaning product should be tested on a small area prior to cleaning the fabric. Do NOT use abrasives or harsh cleansers as they can damage the fabric. Dab with a cloth or towel to prevent water spots and roll shade down to the window sill to allow the fabric to air-dry.

⚠ WARNING

STRANGULATION HAZARD: Young children can be strangled by cords. Immediately remove this product if a cord longer than 22cm or a loop exceeding 44cm around becomes accessible.



For french installation instructions, scan the QR code.

HOW TO OPERATE

CAUTION: Do not lower the shade past the ordered length because damage may occur to the shade.

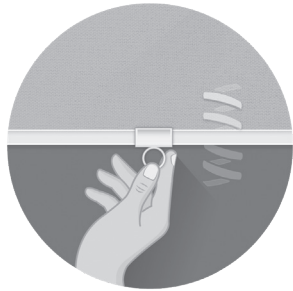

SPRINGDRIVE™

1. To lower your shade, grasp the bottom bar (handle) from the centre-point and gently pull the shade down to desired position.
2. To raise your shade, give a slight pull on bottom bar handle, and the shade will raise automatically in a gradual and controlled motion, stopping at the top.

TIPS

- o Do not pull the fabric beyond the ordered height. Pulling fabric beyond your requested height will expose the tube and could potentially damage your shade.
- o To install the **bottom rail handle**, secure the bottom rail with one hand to prevent the shade from moving. With your other hand, slowly and carefully slide the handle to the centre of the bottom rail.
- o Shade **MUST** be operated from the **centre of the bottom rail** to avoid telescoping and damaging the fabric. If applicable, please ensure the bottom rail handle is positioned in the centre of the shade.

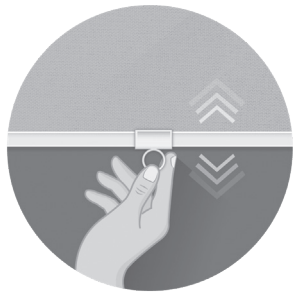

FREEMOTION™

1. To lower your shade, grasp the bottom bar (handle) from the centre-point and gently pull the shade down to desired position.
2. To raise your shade, using the bottom bar, gently guide the shade up to desired position.

TIPS

- o Operate the shade gradually and evenly, do not quickly force the shade up or down.
- o Shade **MUST** be operated from the **centre of the bottom rail** to avoid telescoping and damaging the fabric. If applicable, please ensure the bottom rail handle is positioned in the centre of the shade.
- o For High-Lite Shades, pull the bottom rail straight down ensuring it is not tilted forward. Rotating the bottom rail may cause the fabric to cinch or get damaged.
- o For High-Lite shades wider than 60" you **SHOULD ALWAYS** operate the shade with two hands to support the bottom rail and ensure fabric isn't creased or cinched.

Tension Adjustment

*Tension can be adjusted by rotating the dial (located on left side of shade).

- If shade is raising on its own, **loosen** the tension by turning the dial **clockwise**
- If shade is lowering on its own, **increase** tension by turning the dial **counter-clockwise**.

For shades installed with **reverse roll**, dial will be located on the right side of the shade.

- If shade is raising on its own, **loosen** the tension by turning the dial **counter-clockwise**.
- If shade is lowering on its own, **increase** tension by turning the dial **clockwise**.

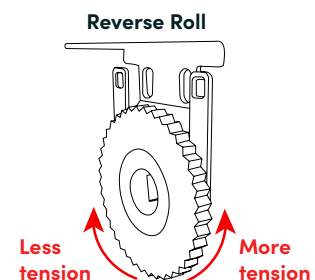
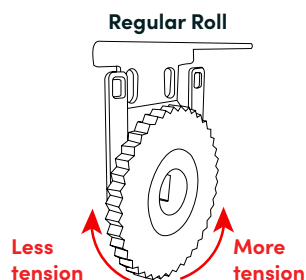

For french instructions, scan the QR code.

HOW TO OPERATE

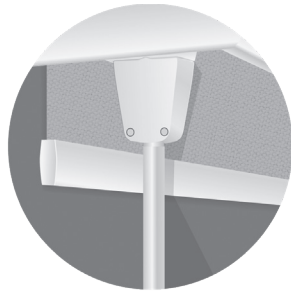

WANDCONTROL™

1. To operate your shade, gently pull down on the wand repeatedly until shade reaches desired position.
2. If the shade operates in the opposite direction, securely dock the wand into the housing and twist the handle clockwise or counterclockwise until you hear a click. The click indicates change in direction.

TIPS

- o Pump the wand gradually.
- o Avoid pulling the wand to the end of the cord travel. The abrupt stop may damage the mechanism and potentially loosen the mounting screws over time.
- o When installing into drywall, anchors or plugs **MUST** be used.
- o Only twist the wand when docked in the housing unit. Twisting the cords (in an open position) may damage the mechanism.

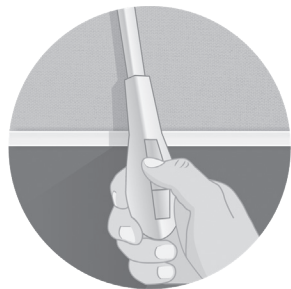

E-TOUCH™

* To change between Roller and Sheer Horizontal mode, press the PROGRAM button 3x. The motor will beep 4x in response.

NOTE: when using the PROGRAM button, be sure to press and hold firmly.

FOR ROLLER & HIGH-LITE:

1. Press UP button to raise shade. Shade will automatically stop when it reaches the upper limit.
2. Press DOWN button to lower shade. Shade will automatically stop when it reaches the lower limit.
3. Press STOP to stop your shade while in motion.

FOR SHEER HORIZONTAL:

1. Tap UP button to move the shade up in small increments. Hold UP button for 2 sec. to automatically raise shade.
2. Tap DOWN button to move the shade down in small increments. Hold DOWN button for 2 sec. to automatically lower shade.
3. Press STOP to stop your shade while in motion.

4. Set Middle Stop Position:

- a. Move the shade to desired middle stop position.
- b. Press and hold the PROGRAM & UP buttons for 3 seconds until motor beeps 4x.
- c. To change middle stop position, repeat steps a & b.
- d. Only one middle position is allowed .

5. When stationary, STOP button can be used to move shade to a middle stop position.

6. Reset Shade Limits

- a. Press and hold PROGRAM button for 5 seconds until motor beeps 4x. Limits are now clear.

7. Setting Upper/Lower Limits

- a. Set Upper Limit: Raise shade to desired position. Press PROGRAM button, motor will beep
- b. Set Lower Limit: Lower shade to desired position. Press PROGRAM button, motor will beep.

8. Change Motor Rotation

- a. To reverse motor direction, press and hold the PROGRAM & STOP buttons for 2 sec. Shade will beep 3x.

TIPS

- o E-Touch can be charged with any Micro-USB to USB cable and a charging cube.
- o Motor will take 7 hours to fully charge. Ensure you're using a DC 5V 1A charging cube.

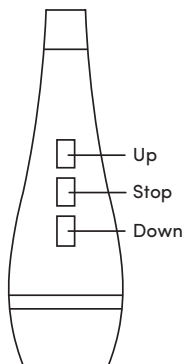
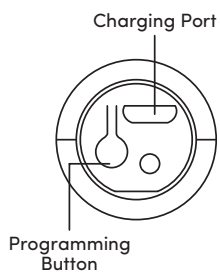

Remote User & Programming Guide

Your shades have been custom programmed by our factory to automatically stop at the top and bottom of your windows. Please consult this guide for proper shade operation and programming.

5 Channel Handheld Remote

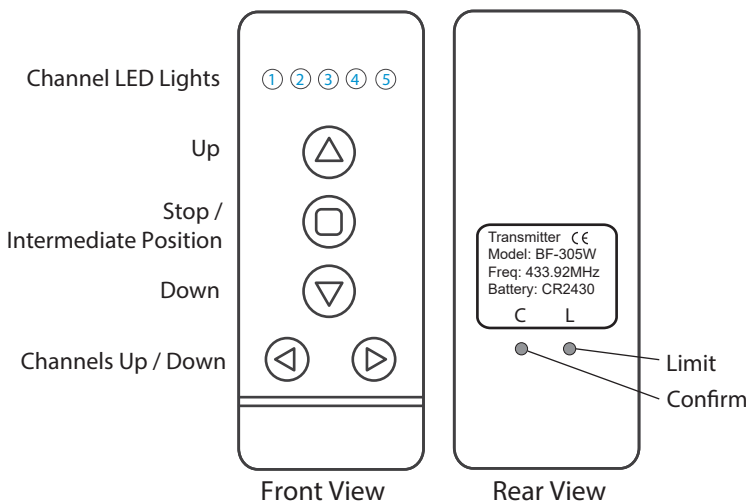

Operating Instructions

Raise Shade: Press and hold button for 1-2 seconds.

Lower Shade: Press and hold button for 1-2 seconds.

Stop Shade: Press button while shade is in motion.

Intermediate Position: Press button when shade is stopped (must be set by user, see pg. 2 for setup).

Tilt Shade (Zebra & Sheer Horizontal Shades only):
Press and release or button.

Change Channels: Press or arrows to change channels. The numbered LED lights at the top of the remote indicate the current channel. When all LED lights are on, the remote will operate all shades.

5 Channel Wall Remote

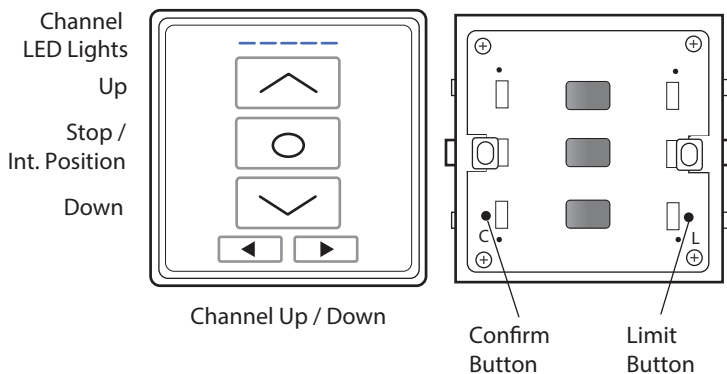

Operating Instructions

Raise Shade: Press and hold button for 1-2 seconds.

Lower Shade: Press and hold button for 1-2 seconds.

Stop Shade: Press button while shade is in motion.

Intermediate Position: Press button when shade is stopped (must be set by user, see pg. 2 for setup).

Tilt Shade (Zebra & Sheer Horizontal Shades only):
Tap or buttons.

Change Channels: Press or arrows to change channels. The numbered LED lights at the top of the remote indicate the current channel. When all LED lights are on, the remote will operate all shades.

Pairing a New Motor to Your Handheld Remote or Wall Remote

- 1) **Press and hold** the red button on motor (see figure 1) for 1-2 seconds until the shade beeps 1x.
- 2) Select the desired channel to which you want to program the motor.
- 3) Using a pen or paperclip, gently press the confirm button marked "C" on the remote. The shade will beep 3x to confirm successful programming.

Operating Shades as Group: By default, when all LED lights on your remote are on, it will control ALL shades within range. If you wish to create your own group on another channel, simply repeat steps 1-3 for additional motors but pair the motors to the same channel.

Removing a Motor From Your Handheld Remote or Wall Remote

(Don't worry, this will not erase the motor's limit positions)

- 1) **Press** the "C" button three times. Motor will beep each time button is pressed.

ATTENTION: Before attempting any of the programming functions in this section, **you must ensure the motor is NOT grouped on the same channel with any other motor(s).**

Follow these steps to isolate a grouped motor for individual programming:

- a) Disconnect the power from other motor(s) by either unplugging the battery wand(s) **OR**
- b) Switch the RF button on the motor head to off for all other shades.

Reverse Motor Rotation Direction

- 1) Press and hold the "Limit" and "Stop" buttons simultaneously until the motor beeps.

Setting New Upper and Lower Limits

- 1) Select the channel of the shade you want to adjust.
- 2) Press and **hold** the Limit button marked "L" on your remote for 5-6 seconds until the motor beeps.
- 3) Press "down" button to send shade down. **WARNING: ⚠️ MOTOR WILL NOT STOP ON ITS OWN!**
- 4) Press "stop" button once the shade reaches desired position at the window sill. Once stopped, the shade can be finely adjusted in small increments by pressing "up" or "down" buttons.
- 5) When satisfied, use a pen or paperclip to press "Confirm" until shade beeps to set the lower limit stop position.
- 6) Press "up" button to send shade up. **WARNING: ⚠️ MOTOR WILL NOT STOP ON ITS OWN!**
- 7) Press "stop" button when shade is **2" - 3" from top to prevent damage to the shade.** Once stopped, shade can be finely adjusted in small increments by pressing "up" or "down" buttons.
- 8) When satisfied, use a pen or paperclip to press "Confirm" until shade beeps to set the upper limit stop position.

Setting A "Favourite" Intermediate Stop Position

- 1) Bring shade to desired intermediate stop position (i.e 50% height, window transom, latch etc).
- 2) Press and hold the "Limit" and "Up" buttons simultaneously until the motor beeps.

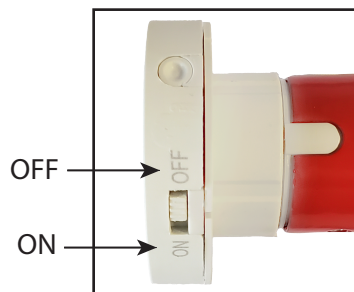
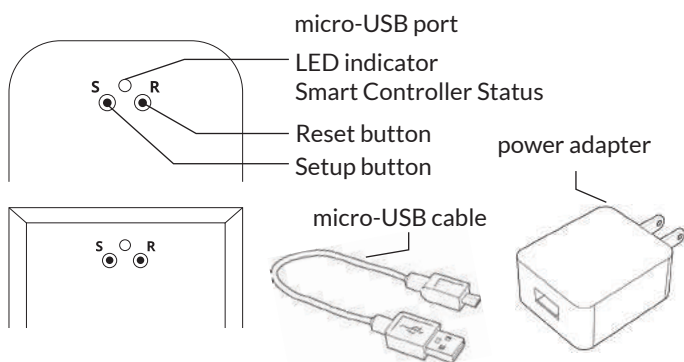

Fig. 1

SETUP CODE CODE DE CONFIGURATION

N2421

Getting to know your Smart Controller



Smart Controller Status:
Flashing blue - Hotspot available
Flashing green - Connecting to the WiFi network
Pulsing cyan/blue-green - Connected to the Internet

Getting Started

- 1 Download the Neo Smart Blinds app**

Download the app to your phone or tablet by searching **Neo Smart Blinds** on Google Play or the App Store.
Note: Do not install Neo Smart Blinds Blue
- 2 Plug in your Smart Controller in reach of your home WiFi**

Choose a place not too far from your home router or a place you know has good WiFi signal strength. You will be able to change its location after, if necessary.
- 3 Create an account and choose the setup code written on the cover**

After opening the app, tap on Create one to create a new account. Enter a valid email address and choose a password, select the region time zone from the place where the Smart Controller will be located. Choose the setup code written in the cover and tap on Register.
- 4 Follow the app step by step to add the Smart Controller**

Have in hand the home WiFi password. It will be necessary to connect the Smart Controller to the Internet.
Note: Some Android users won't be connected quickly to the hotspot. If it is the case, please wait about 10 seconds before returning to the app. During this time, your device may notify you that the hotspot does not have Internet access, and will prompt you whether you want to remain connected. You need to select the option that will allow you to keep connected before returning to the app.

System requirements

- A strong WiFi signal (3 bars or more) in the location where you will setup your Smart Controller.
- The Smart Controller only supports 2.4GHz WiFi (IEEE 802.11b/g/n), not 5GHz. WiFi security needs to be set to WPA-PSK or WPA2-PSK.
- A smartphone or tablet running Android 5.0 (Lollipop) or higher, or iOS 8 or higher is needed.

Troubleshooting

The home WiFi doesn't appear in the step 4

Try rescanning, if the problem persists, you will need to reposition the Smart Controller to a place with stronger WiFi signal. In this case, exit the process (tap on the menu, then tap Your Rooms), replace the Smart Controller and start over.

The Smart Controller LED in the bottom is not blinking blue

The process fails in the last step

Press the S button for 10 seconds, then press the R button once and start over. Pay special attention when typing the WiFi password.

Need more help?

Visit neosmartblinds.com/smartcontroller for detailed instructions about how to use the app and troubleshooting.

Integrations

Smart home devices

Visit neosmartblinds.com/smartcontroller-integrations for detailed information about connecting to Amazon Alexa, Google Home and other systems.

Control4

Please send an email to tech@neosmartblinds.com with your name, your email and your company's name. This information is necessary to always send to you any further driver update.

Legal Information

FCC

This equipment has been tested and found to comply with the limits for a Class B digital device, pursuant to Part 15 of the FCC Rules. These limits are designed to provide reasonable protection against harmful interference in a residential installation. This equipment generates uses and can radiate radio frequency energy and, if not installed and used in accordance with the instructions, may cause harmful interference to radio communications. However, there is no guarantee that interference will not occur in a particular installation. If this equipment does cause harmful interference to radio or television reception, which can be determined by turning the equipment off and on, the user is encouraged to try to correct the interference by one of the following measures:

- Reorient or relocate the receiving antenna.
- Increase the separation between the equipment and receiver.
- Connect the equipment into an outlet on a circuit different from that to which the receiver is connected.
- Consult the dealer or an experienced radio/TV technician for help

Contains transmitter module FCC ID: COFWNMNB11

To comply with FCC/IC RF exposure limits for general population/uncontrolled exposure, the antenna(s) used for this transmitter must be installed to provide a separation distance of at least 20 cm from all persons and must not be co-located or operating in conjunction with any other antenna or transmitter.

IC

This device complies with Industry Canada's licence-exempt RSSs. Operation is subject to the following two conditions:

- This device may not cause interference; and
- This device must accept any interference, including interference that may cause undesired operation of the device.

This device meets the exemption from the routine evaluation limits in section 2.5 of RSS102 and users can obtain Canadian information on RF exposure and compliance.

Contains transmitter module IC: 10293A-WMNB11

This End equipment should be installed and operated with a minimum distance of 20 centimeters between the radiator and your body.

